



## BYCN / BYCS Series Butterfly Valves

2" TO 8" PVC

### KEY FEATURES

- Distinctive Ergonomic Handle with Lockout Feature
- Wafer Body Design
- Fits ANSI 150 or PN10 Flange Patterns
- PVC Body with PVC Disc
- One-Piece Stainless Steel Stem 316 Grade for BYCN/410 Grade for BYCS
- NSF / ANSI-61 and NSF / ANSI 372 Listed (BYCN Series)

### OPTIONS

- Gear Operators

### MATERIALS

- PVC Cell Class 12454 per ASTM D1784
- EPDM Liner and Seals



Certified to  
NSF/ANSI 61 & 372  
BYCN 3" - 8"

## TECHNICAL INFORMATION

### EXPLODED VIEW

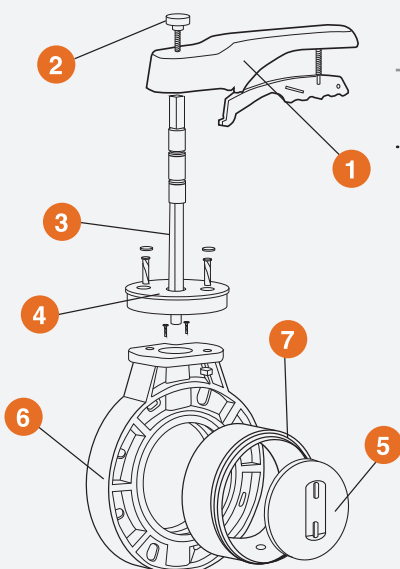

### SELECTION CHART

SERIES	SIZE	BODY MATERIAL	DISC MATERIAL	STEM MATERIAL	LINERS	PRESSURE RATING
BYCN	2" - 8" (DN60 - DN200)	PVC	PVC	316 Grade Stainless Steel	EPDM	150 PSI @ 70°F 10 Bar @ 21°C Non-Shock
BYCS				410 Grade Stainless Steel		

# BYCN / BYCS Series Butterfly Valves

2" TO 8" PVC

## TECHNICAL INFORMATION, CONTINUED

### BYCN/BYCS PARTS LIST

1. Operator (Lever or Gear)
2. Bezel (Screw)
3. SSTL Stem
4. Throttle Plate with Screws
5. Disc
6. Body
7. Liner

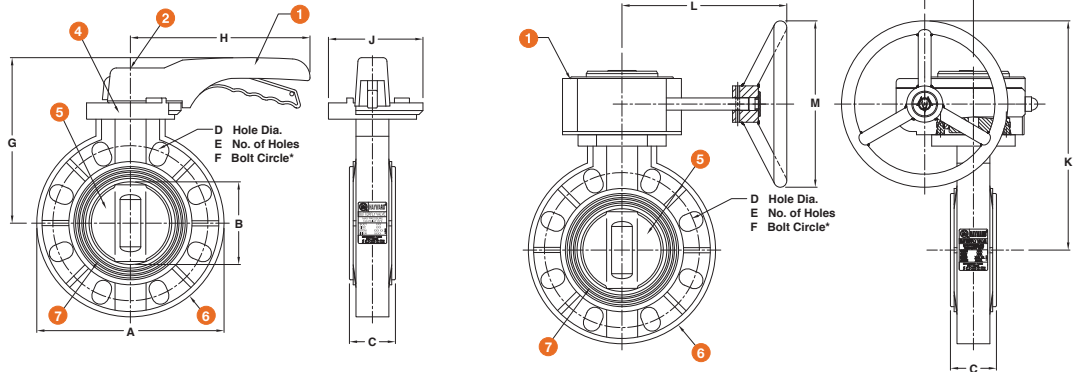

### DIMENSIONS

SIZE in / DN	A in / mm	B in / mm	C in / mm	D in / mm	E in / mm	F in / mm	G in / mm	H in / mm	J in / mm	K in / mm	L in / mm	M in / mm	N in / mm
2 / 50	6.30 / 160	2.13 / 54	1.75 / 44	.75 / 19	4 / 102	4.75 / 121	6.37 / 162	8.66 / 220	4.26 / 108	9.52 / 242	9.69 / 246	8.00 / 203	2.36 / 60
2 1/2 / 65	7.08 / 180	2.64 / 67	1.89 / 48	.75 / 19	4 / 102	5.50 / 140	6.73 / 171	8.66 / 220	4.26 / 108	9.88 / 251	9.69 / 246	8.00 / 203	2.36 / 60
3 / 80	7.70 / 196	3.27 / 83	2.09 / 53	.75 / 19	4 / 102	6.00 / 152	7.44 / 189	9.80 / 249	8.43 / 214	10.59 / 269	9.69 / 246	8.00 / 203	2.36 / 60
4 / 100	9.06 / 230	3.98 / 101	2.24 / 57	.75 / 19	8 / 203	7.50 / 191	7.95 / 202	9.80 / 249	4.26 / 108	11.10 / 282	9.69 / 246	8.00 / 203	2.36 / 60
5 / 125	10.00 / 254	5.00 / 127	2.68 / 68	.88 / 22	8 / 203	8.50 / 216	9.96 / 253	12.60 / 320	5.84 / 148	12.34 / 313	9.69 / 246	8.00 / 203	2.36 / 60
6 / 150	11.19 / 284	5.98 / 152	2.87 / 73	.88 / 22	8 / 203	9.50 / 241	10.48 / 266	12.60 / 320	5.84 / 148	12.86 / 326	9.69 / 246	8.00 / 203	2.36 / 60
8 / 200	13.54 / 344	7.88 / 200	3.62 / 92	.88 / 22	8 / 203	11.75 / 298	12.17 / 309	12.60 / 320	5.84 / 148	14.55 / 370	9.69 / 246	8.00 / 203	2.36 / 60

Dimensions are subject to change without notice – consult factory for installation information

### OPERATING TEMPERATURE/PRESSURE

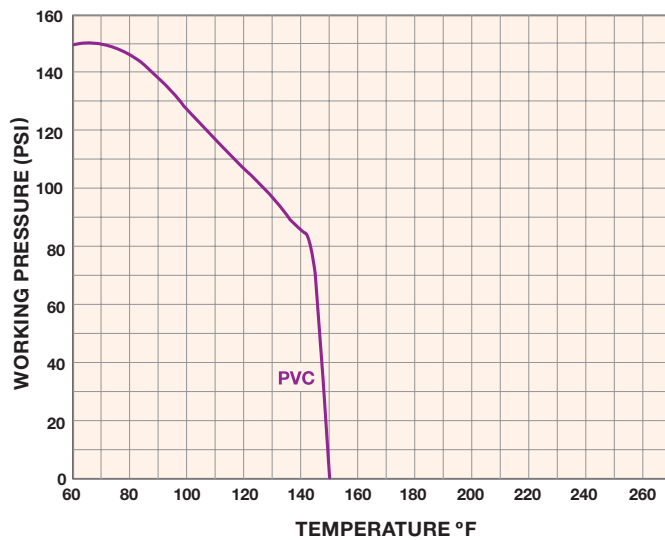

### Cv VALUES

SIZE in / DN	DISC ANGLE					FULL OPEN POSITION
	15°	30°	45°	60°	75°	
2 / 50	1	6	24	32	84	120
2-1/2 / 65	3	13	50	108	175	250
3 / 80	4	15	60	129	210	300
4 / 100	7	24	94	202	329	470
5 / 125	13	42	166	357	581	830
6 / 150	18	55	220	473	770	1,100
8 / 200	90	125	500	1,075	1,750	2,500

### PRESSURE LOSS CALCULATION FORMULA

$$\Delta P = \left[ \frac{Q}{C_v} \right]^2$$

$\Delta P$  = Pressure Drop  
 $Q$  = Flow in GPM  
 $C_v$  = Flow Coefficient



Hayward is a registered trademark  
of Hayward Industries, Inc.  
© 2018 Hayward Industries, Inc.

USA: 1.888.429.4635 • Fax: 1.888.778.8410 • One Hayward Industrial Drive • Clemmons, NC 27012 • Email: hfcsales@hayward.com  
 Canada: 1.888.238.7665 • Fax: 1.905.829.3636 • 2880 Plymouth Drive • Oakville, ON L6H 5R4 • Email: hflowcanada@hayward.com  
 Visit us at: haywardflowcontrol.com